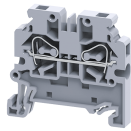

CXS6

**connectwell**  
 THE RIGHT CONNECTION

## 6 sq.mm Spring Clamp Feed Through Side Entry Terminal Blocks

The Spring Clamp is operated by using a screw driver to provide an access to the wire through an opening in the spring clamp. The inserted wire gets clamped on to the current bar when the screw driver is removed.

### TECHNICAL DATA

Rated Voltage	1000 V
Rated Current	41 A
Housing Material	Polymide
Standard Colour	Grey
Product Function	Feed Through
Wire Entry Orientation	Side
Mounting Possibility	DIN 35/DIN 35-15 Rail
Operated by	Screw Driver
Rated Surge Voltage	8 KV
Pollution Degree	3

### CONNECTION DATA

Conductor Cross Section Stranded min.	0.2 mm <sup>2</sup>
Conductor Cross Section Stranded max.	6 mm <sup>2</sup>
Conductor Cross Section AWG/Kcmil min	24 AWG
Conductor Cross Section AWG/Kcmil max	10 AWG
Conductor Cross Section Stranded with Ferrule/Lug min	0.2 mm <sup>2</sup>
Conductor Cross Section Stranded with Ferrule/Lug max	6 mm <sup>2</sup>
2 Conductors with same Cross Section Stranded with TWIN Ferrule/Lug min	0.2 mm <sup>2</sup>
2 Conductor with same Cross Section Stranded with TWIN Ferrule/Lug max	6 mm <sup>2</sup>
Stripping Length	14 mm

### DIMENSIONS

Height	49 mm
Height with DIN 35 x 15 mm rail	57.25 mm
Height with DIN 35 x 7.5 mm rail	49.75 mm
Length	55.4 mm
Width (Thickness)	8 mm

### ORDERING INFORMATION

CAT. NO.	DESCRIPTION	STD. PACK
CXS6	6 sq.mm Feed Through Spring Clamp Side Entry Terminal Block in Grey colour	100

### ACCESSORIES

IMAGES	CAT. NO.	DESCRIPTION	STD. PACK
	CA701-1M	Din 35 Rail unslotted 1 meter	50

### ACCESSORIES

IMAGES	CAT. NO.	DESCRIPTION	STD. PACK
	CA701-2M	Din 35 Rail unslotted 2 meter	50
	CA701-2M-S	Din 35 Rail slotted 2 meter	50
	CA701-1M-S	Din 35 Rail slotted 1 meter	50

	CA701-15-1M	Din 35 Rail 15 deep unslotted 1 meter	50
	CA701-15-1M-S	Din 35 Rail 15 deep slotted 1 meter	50
	CA701-15-2M	Din 35 Rail 15 deep unslotted 2 meter	50
	CA701-15-2M-S	Din 35 Rail 15 deep slotted 2 meter	50

	EPCXS6	End Plate in Grey Colour	50
--	--------	--------------------------	----

	JX6/2	Shorting Link for 8 mm wide TB	100
	JX6/3	Shorting Link for 8 mm wide TB	50
	JX6/4	Shorting Link for 8 mm wide TB	50
	JX6/10	Shorting Link for 8 mm wide TB	10

	CA509/K8	Marking Tag with Vertical printing.	100
--	----------	-------------------------------------	-----

	CA103	EndClamp in Polyamide suitable for Din 35/Din 35-15 rails	50
--	-------	---	----

	CA104	EndClamp in Polyamide suitable for Din 35/Din 35-15 rails	50
--	-------	---	----

	GMH8	Group Marker suitable for mounting on CA103	100
--	------	---	-----

	GMH8N	Group Marker suitable for mounting on CA103	100
--	-------	---	-----

### NOTES

All the values mentioned are tentative and might change.

CXS6

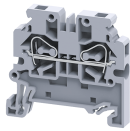

**connectwell**  
THE RIGHT CONNECTION

**RATINGS AS PER STANDARDS**

STANDARDS	UL 1059	CSA C.22.2 No:158	IEC/EN60947-7-1
Conductor Cross Section Stranded min.	24 AWG	24 AWG	0.2 mm <sup>2</sup>
Conductor Cross Section Stranded max.	8 AWG	8 AWG	6 mm <sup>2</sup>
Rated Voltage	600 V	600 V	1000 V
Rated Current	50 A	50 A	41 A